

# Fire safety in communal areas

Keeping you safe





# Fire Safety in Communal Areas

## You must not store items in communal areas.

As your landlord, we have an obligation to ensure your building and the communal areas within it meet fire safety regulations. This includes making sure in the event of an emergency, everyone must be able to escape quickly and safely.

Items such as mobility scooters, buggies or bikes can cause obstructions to escape routes if you or somebody else in your building needed to get out in a fire. Even small, seemingly harmless items such as door mats or plant pots can form an obstruction if it is dark and smoky. In a fire, people may stay close to walls to help guide them if they can't see through thick smoke.

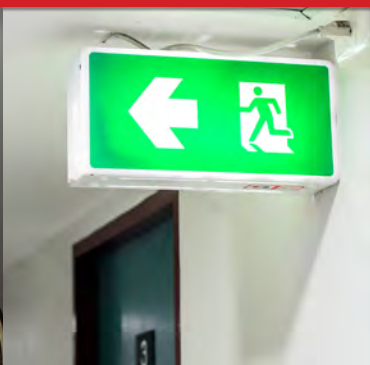
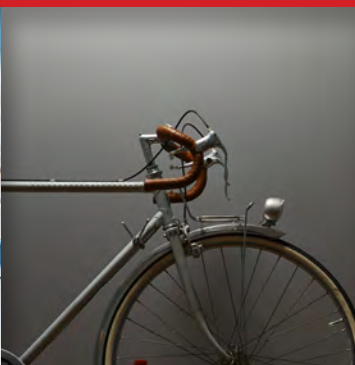

For your safety, we have a zero-tolerance policy towards items in communal areas, which includes stairways, lifts, landings and hallways.

### Please remember:

- Keep all communal areas clear of obstructions, for example plant pots, prams, mobility scooters and bikes
- Do not wedge fire doors open and ensure fire doors are closed properly into the frame
- Place all rubbish in the bins provided
- Report any damage to lights or fire alarms promptly
- Do not tamper with any fire or smoke detection system

If personal items are found in a communal area you will be asked to remove them. If you fail to do so, we will remove and dispose of the items.

For more information, or if you have a question about fire safety, please contact your Housing Officer or call us on **0800 131 3348** (landline) or **0300 123 3511** (mobile).

Thank you for your co-operation.



**This leaflet can be translated into other languages,  
large print and Braille, or recorded onto an audio CD.  
Please contact your local office for details.**

**0800 131 3348 (landline) 0300 123 3511 (mobile)**

**[contactus@sanctuary-housing.co.uk](mailto:contactus@sanctuary-housing.co.uk)**

**[www.sanctuary-scotland.co.uk](http://www.sanctuary-scotland.co.uk)**

** @HelloSanctuary**